

Schematic Layout of Transit Centers: MO

Schematic maps showing details of bus bay allocations for routes at each of the MetroBus Transit Centers can be accessed by scrolling down this document in the order as listed below.

Ballas Transit Center

Address: 790 South New Ballas, Town & Country, St. Louis, MO 63141
Parking Spaces: 80
MetroBus Routes: #48, 49, 58, 98, 57X, 258

Catalan Loop

Address: 8610 South Broadway, St. Louis, MO 63111
Parking Spaces: None
MetroBus Routes: #8, 40, 48, 90

Central West End Transit Center

Address: 410 South Euclid St, St. Louis, MO 63110
Parking Spaces: None
MetroBus Routes: #1, 8, 10, 13, 14, 59, 80, 95, 57X

Union Station/ 18th Street & Clark

Address: 300 S 18th St, St. Louis, MO 63103
Parking Spaces: None
MetroBus Routes: # 4, 8, 10, 11, 30, 32, 41, 74, 78, 80, 94, 97, 99, 40X, 58X, 174X, 410X
MetroLink Station: Union Station

Clayton Transit Center

Address: 275 S. Central Ave., St. Louis, MO 63105
Parking Spaces: 800 (Fee applicable)
MetroBus Routes: # 1, 47, 58, 66, 97, 258
MetroLink Station: Clayton

Delmar Loop Station

Address: 660 Rosedale Ave., St. Louis, MO 63112
Parking Spaces: 362
MetroBus Routes: #2, 16, 91, 97
MetroLink Station: Delmar Loop

Hampton Loop

Address: 7315 Gravois, St. Louis, MO 63101
Parking Spaces: None
MetroBus Routes: #10, 95, 110

Maplewood-Manchester Station

Address: N Forty Drive @ New Ballas Road, St. Louis, MO 63143
Parking Spaces: None
MetroBus Routes: # 2, 32, 57
MetroLink Station: Maplewood-Manchester

North Broadway Taylor Transit Center

Address: 6206 North Broadway, St. Louis, MO 63147
Parking Spaces: None
MetroBus Routes: # 18, 42, 70, 95

North Hanley Station

Address: 4398 Hanley Road, Berkeley, MO 63134
Parking Spaces: 1583
MetroBus Routes: # 4, 34, 35, 37, 38, 39, 47, 49, 61, 77, 79, 98
MetroLink Station: North Hanley

Riverview MetroBus Center

Address: 9000 Riverview, St. Louis, MO 63137

Parking Spaces: 45

MetroBus Routes: #16, 40, 41, 61, 72, 78, 90

Rock Road Station

Address: 7019 St. Charles Rock Rd., St. Louis, MO 63133

Parking Spaces: 183

MetroBus Routes: #2, 30, 32, 33, 35, 64

MetroLink Station: Rock Road

Shrewsbury - Lansdowne I-44 Station

Address: 7201 Lansdowne Ave., St. Louis, MO 63119

Parking Spaces: 800 (25 Long-Term)

MetroBus Routes: #11, 16, 17, 21, 30, 46, 56, 210

MetroLink Station: Shrewsbury - Lansdowne I-44

North County MetroBus Center

Address: 3140 Pershall Rd., St. Louis, MO 63136

Parking Spaces: 57

MetroBus Routes: #47, 71, 72, 74, 76, 77, 78, 79, 174X

BALLAS METROBUS CENTER

Effective Date: March 14, 2016

Ballas Rd

I-64 Ramp

SPEED LIMIT 10



Call A Ride



ONE WAY

MoDot

STOP

#49 Lindbergh North
#98 To Hanley Station
#258 To Clayton Station
#58 To Clayton Station

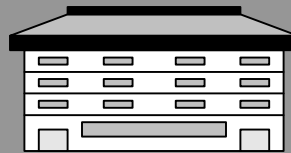

Ballas Transfer Center



ONE WAY

#48 Lindbergh South
#57X Clayton Rd. Exp
#258 To Chesterfield
#58 To Delmar Gardens



Catalan Loop

Effective Date: August 30, 2010

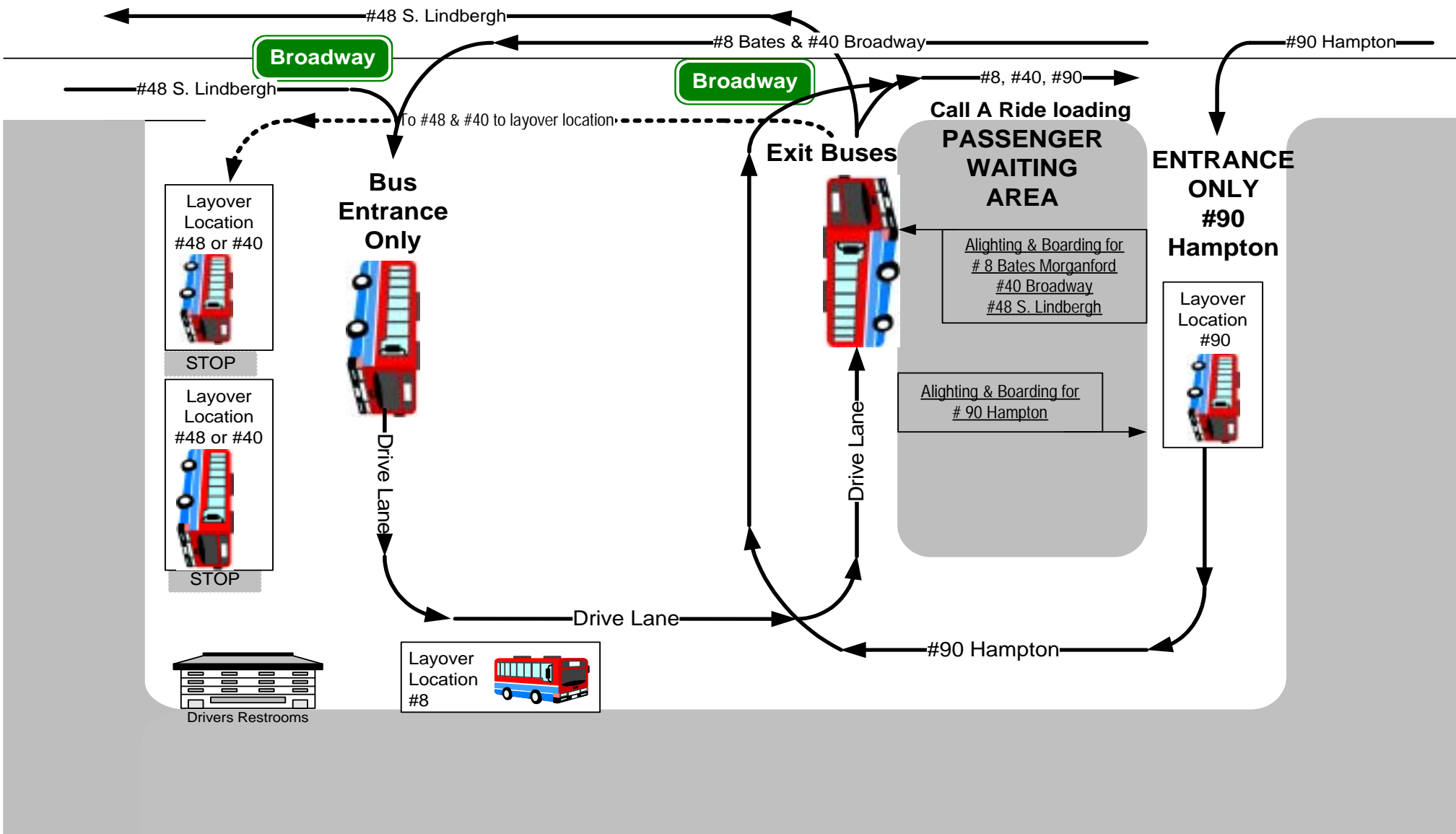
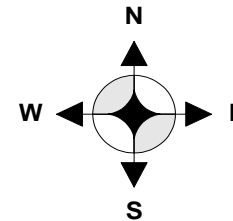



Metro

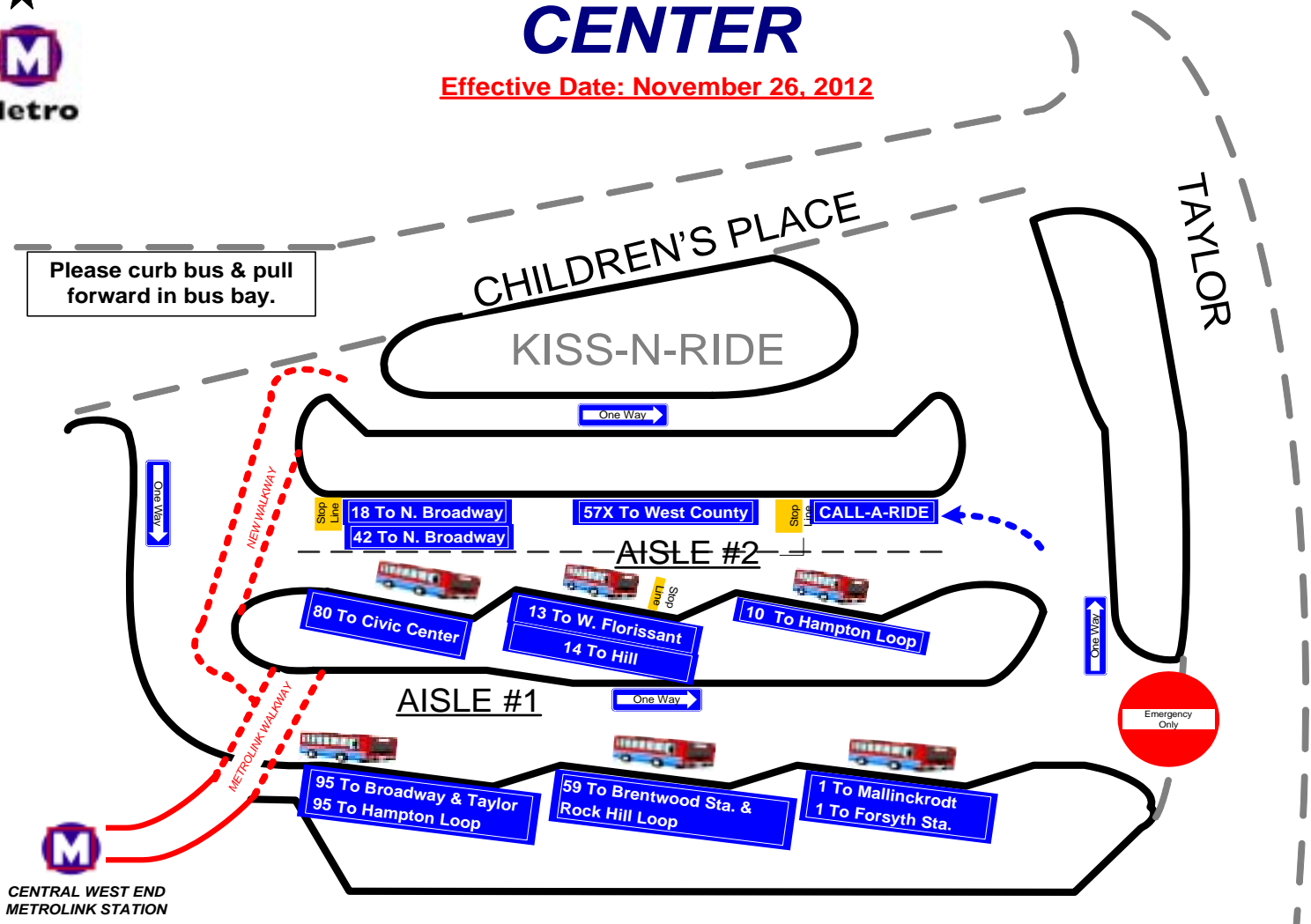

CENTRAL WEST END METROBUS CENTER

Effective Date: November 26, 2012



18th Street & Clark Street Bus Zone Assignments

EFFECTIVE: April 18, 2016

-  Shelter
-  Bench
-  Bus Zone No Parking



Union Station

Market

18th St.

Post Office

Board North on 18th St.
 78 AM Only
 58X PM Only
 410X PM Only

Clark

Board South on 18th St.
 08 To Catalan Loop
 10 To Hampton Loop
 11 To Shrewsbury Sta.
 30 To Shrewsbury Sta.
 32 To Maplewood Sta.
 80 To Loughbough
 40X PM Only

Board North on 18th St.
 10 To CWE Sta.
 30 To Rock Road Sta.
 32 To Rock Road Sta.
 40X AM Only

Board on Clark between 18th & Stairs
 04 To N. Hanley Sta. 41 To RVTC
 73 To So. Co. Mall 78 To NCTC
 74 To NCTC 94 To Westport Plaza
 97 To Clayton Sta. 99 Downtown Trolley
 58X AM Only 410X AM Only

174X
To NCTC

MetroLink Platform

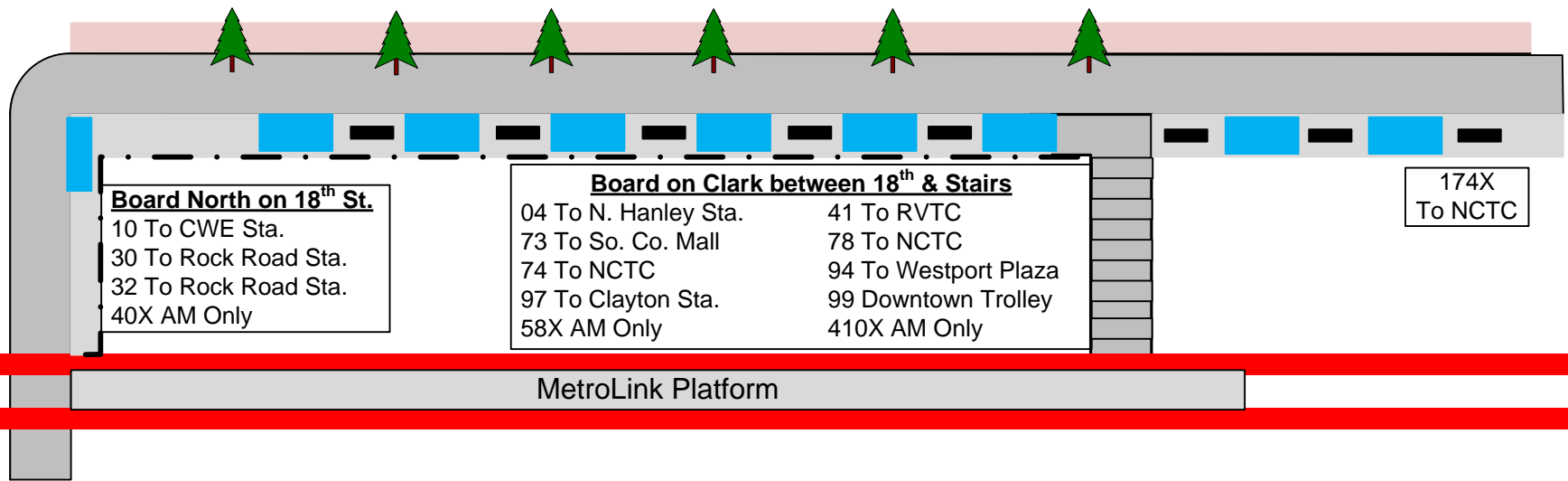

CLAYTON TRANSFER CENTER

Effective Date: March 14, 2016



Metro

Parking
Garage
Exit

Parking
Garage
Entrance

SPEED
LIMIT
5



47 To NCTC

97 To Union Station

SPEED
LIMIT
5

South Meramec

South Central

Call a Ride



58 To Delmar Gardens Chesterfield

258 To Chesterfield Valley

66 To Village Square



Shaw

DELMAR STATION

Effective date: January 8, 2016



Metro

METROLINK

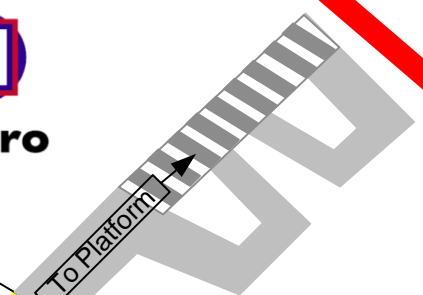

Enright

Des Peres

Rosedale

Delmar

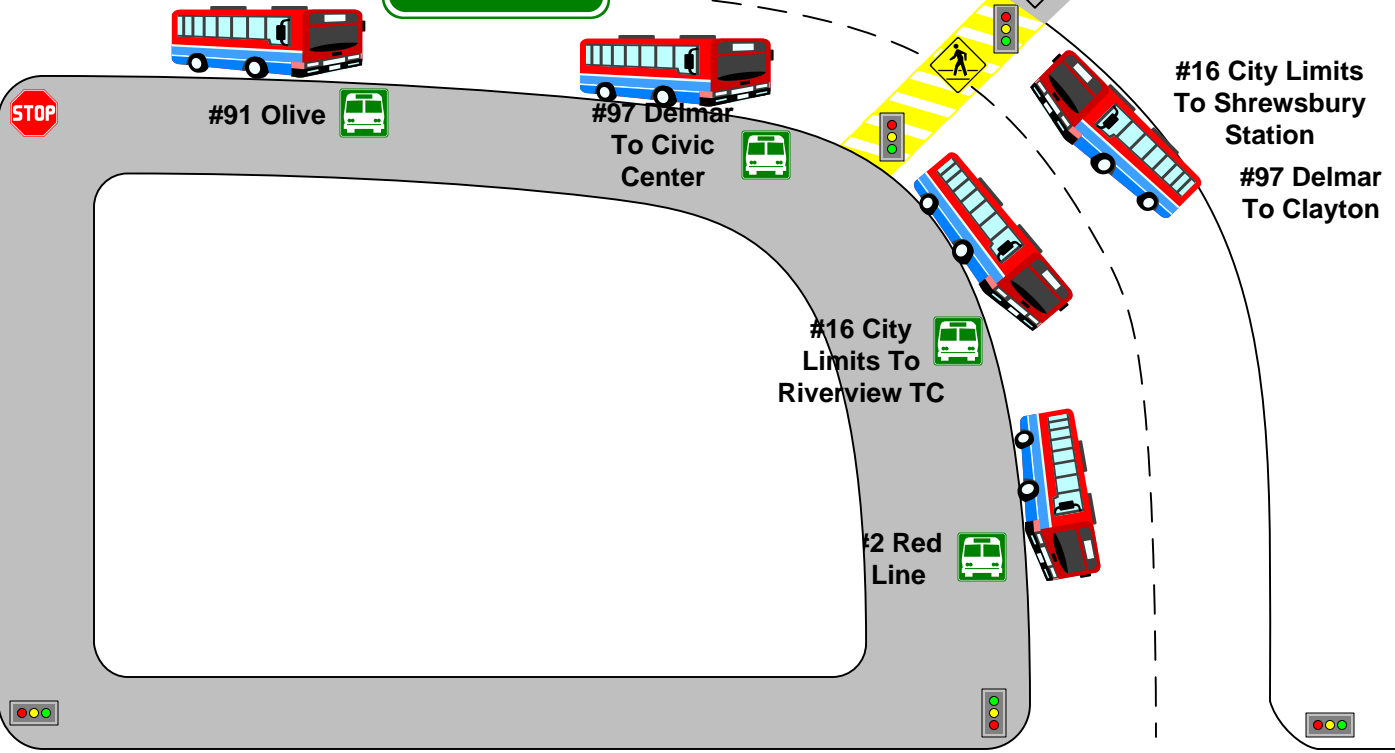

GRAVOIS-HAMPTON TRANSIT CENTER

Effective January 24, 2011

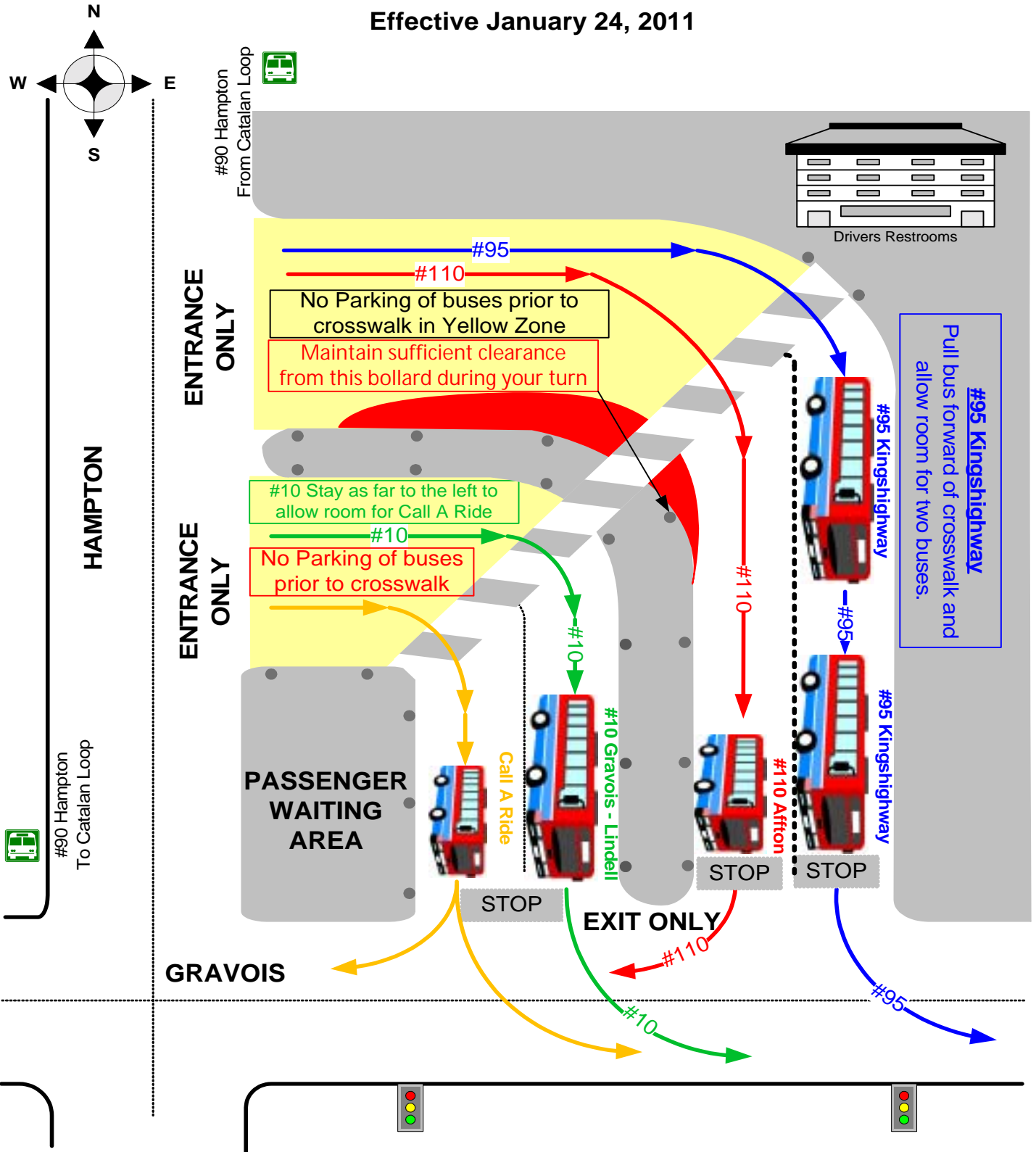

MAPLEWOOD LOOP

Effective: November 29, 2010

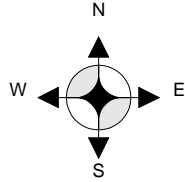

Maplewood Station Platform

Stairs to platform

Elevator

Stairs to platform

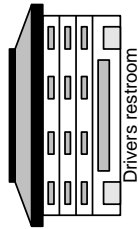

Call a Ride

#2 Red Line

#32 ML King Chouteau
Wildwood

#57 Maplewood
Wildwood

Manchester

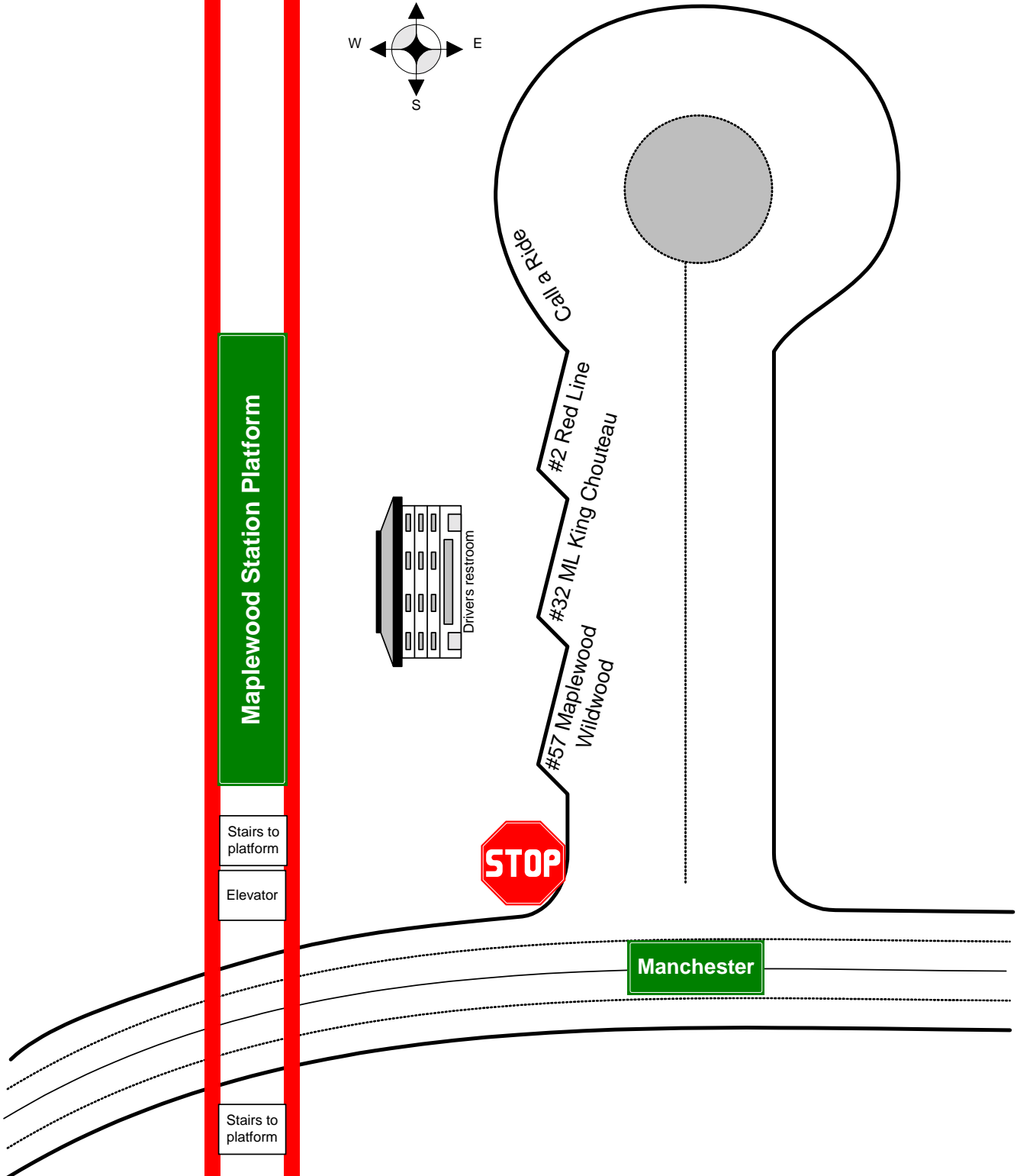

NORTH BROADWAY METROBUS CENTER

Effective Date: June 9, 2014

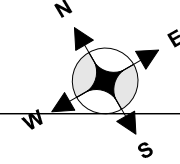

#18 Taylor To CWE
#42 Sarah End of Line

#40 Broadway To Riverview
#36X Bissell Hills To Redman & Hwy 367

BROADWAY



#18 Taylor End of Line
#42 Sarah To CWE

#40 Broadway To Catalan Loop
#36X Bissell Hills To Compton & Spruce

ENTRANCE ONLY

PASSENGER
WAITING
AREA

CAR



TAYLOR

STOP



#95 Kingshighway

STOP

Pull bus to
front bay if no
bus present

EXIT ONLY



#70 Grand

STOP



#70 Grand

STOP

Pull bus to
front bay if no
bus present

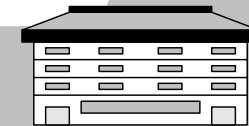

Drivers Restrooms

NORTH HANLEY METROLINK

EFFECTIVE: August 22, 2016

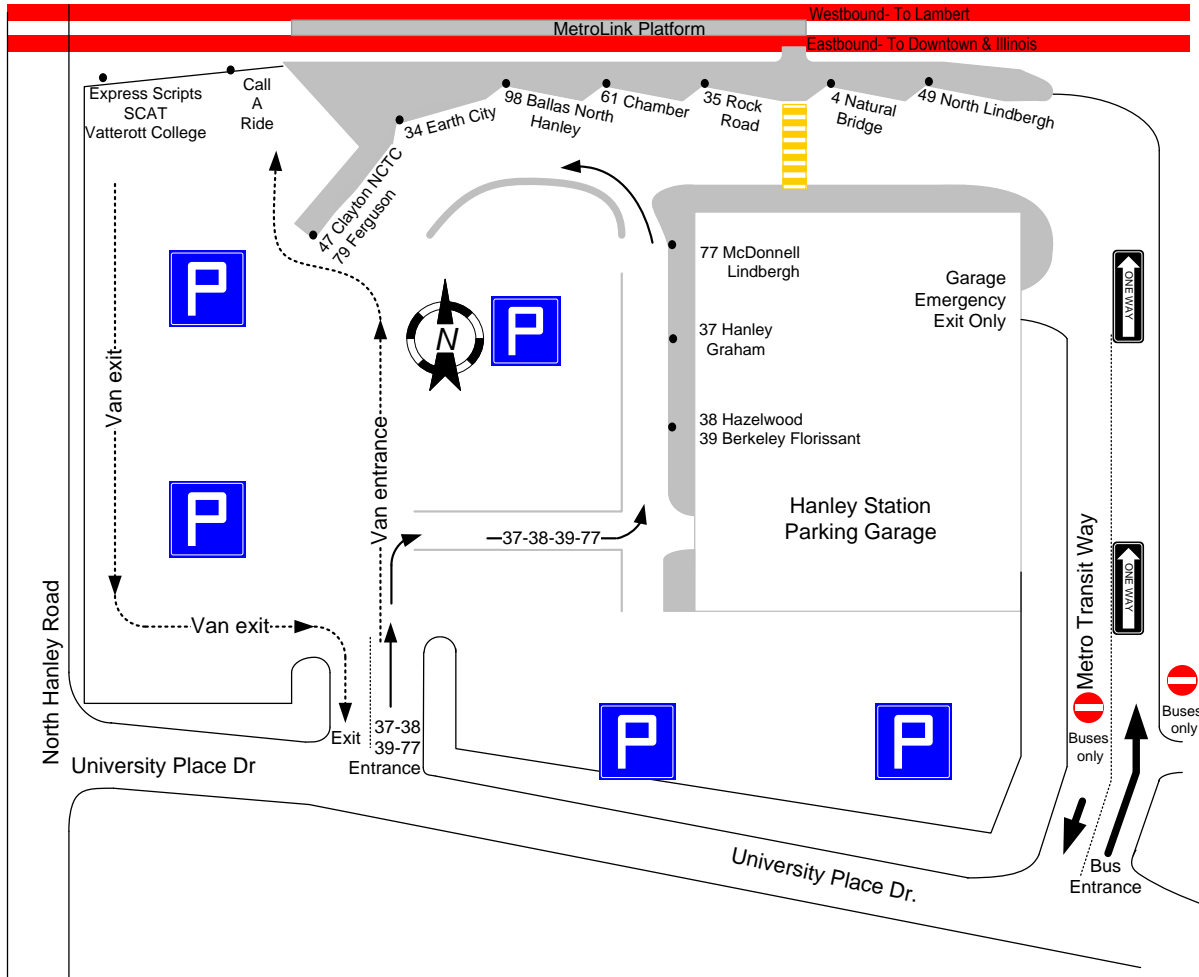

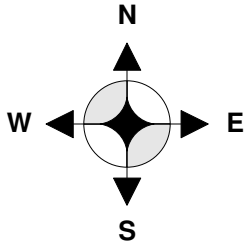

RIVERVIEW METROBUS CENTER

Effective Date: March 14, 2016

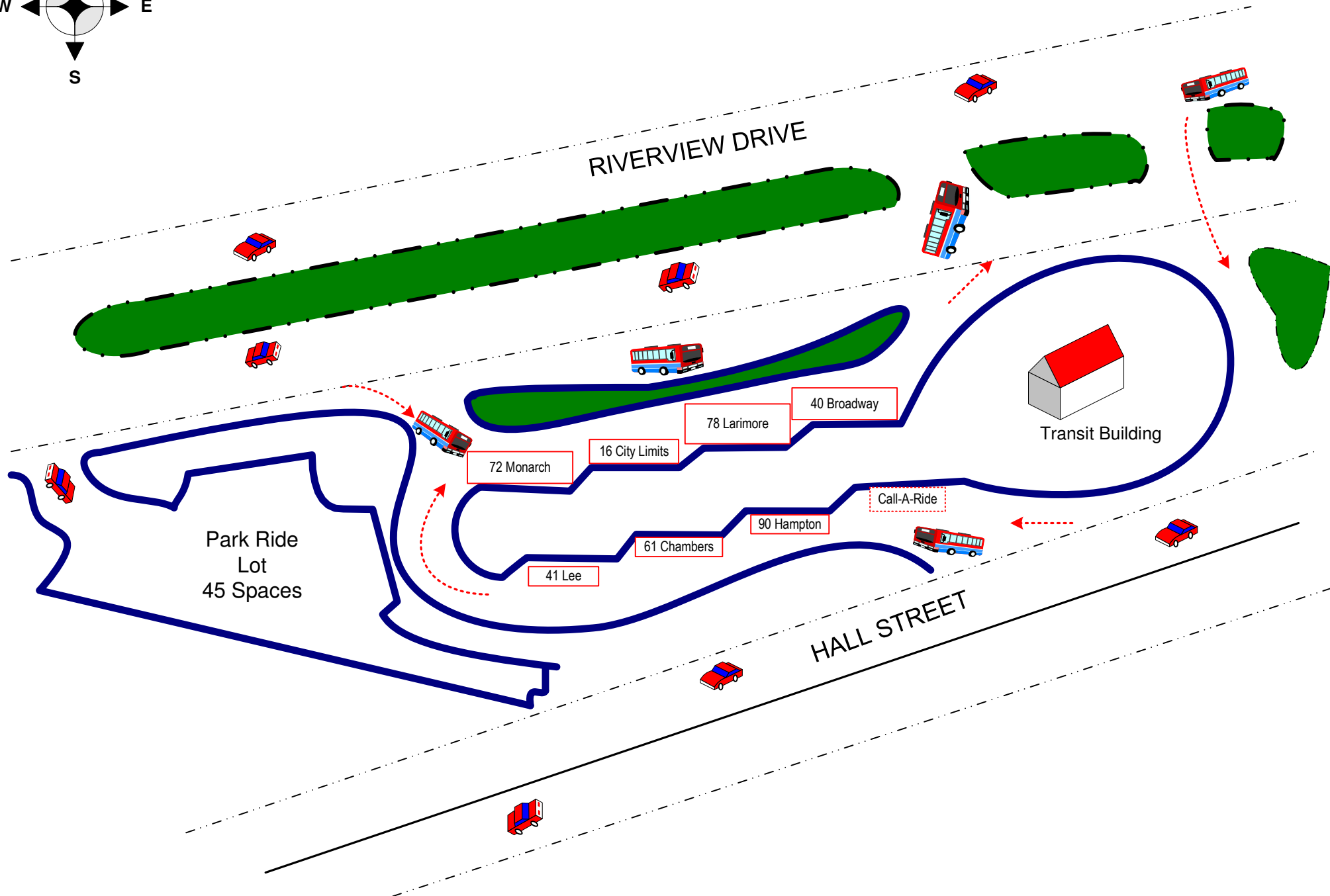

ROCK ROAD STATION

Effective Date: October 10, 2011

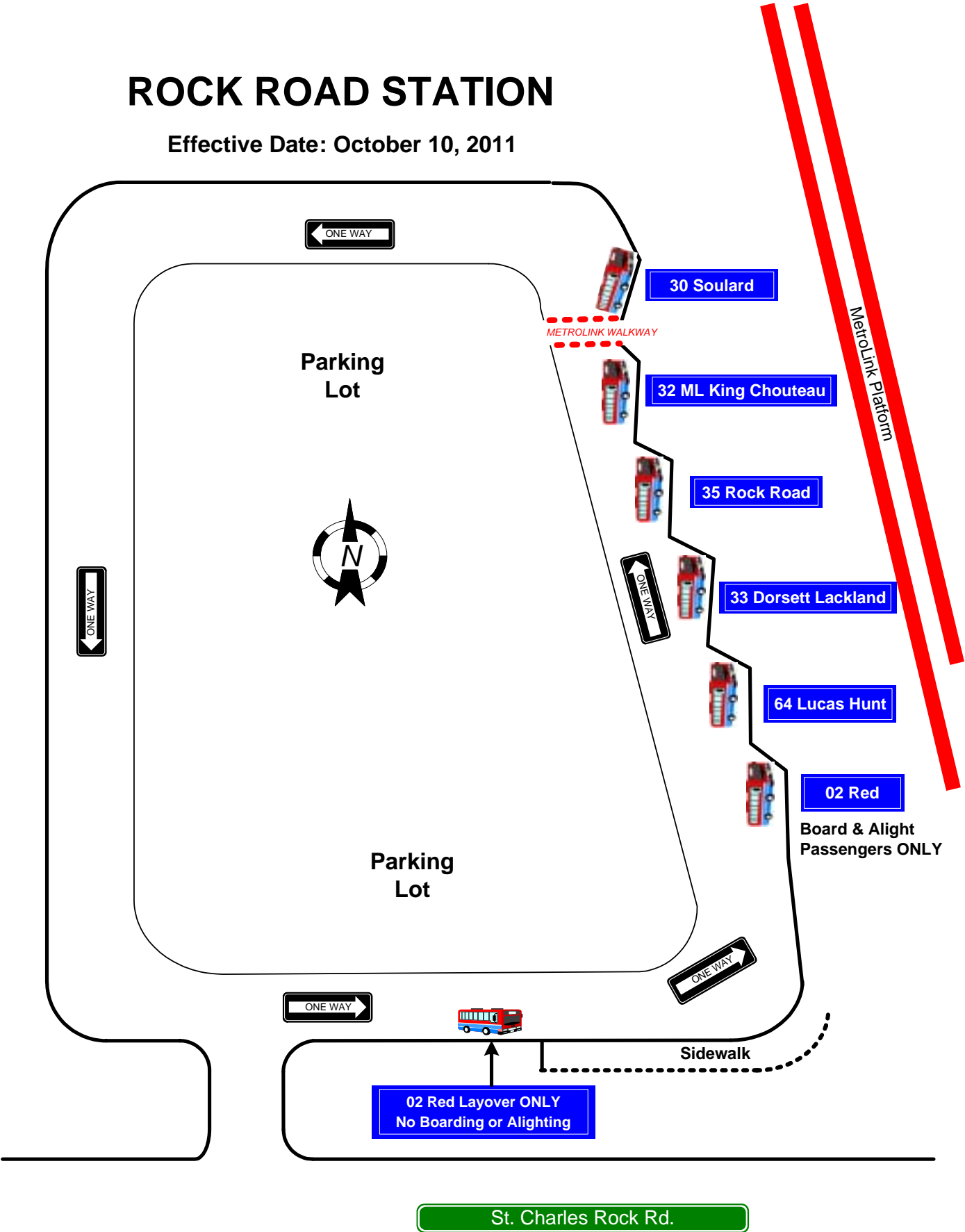



SHREWSBURY METROBUS CENTER

Effective Date: August 30, 2010

Edward Jones to
Maryville Campus

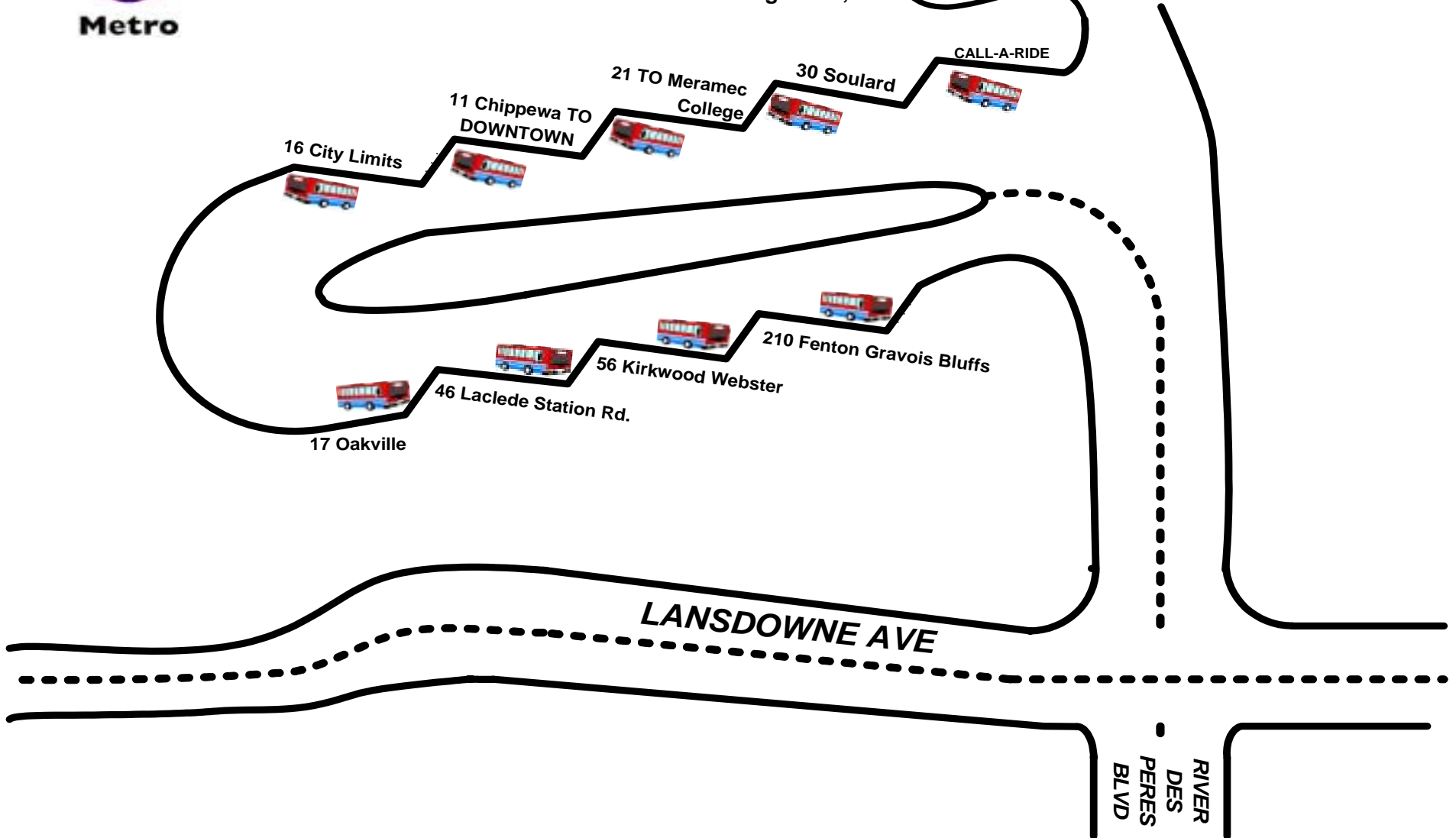

NORTH COUNTY TRANSIT CENTER

Effective Date: March 14, 2016

- #47 Clayton NCTC
- #71 Lilac
- #72 Monarch
- #74 Florissant
- #76 Waterford
- #77 McDonnell Lindbergh
- #78 Larimore
- #79 Ferguson
- #174X North Express
- Call-A-Ride

